

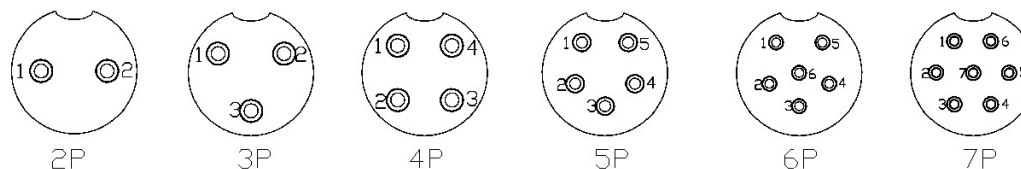

REV	DESCRIPTION	DWN	DATE	APPROVEN
A	FIRST ISSUE	XIEFENG	2022/06/15	Mr.chen

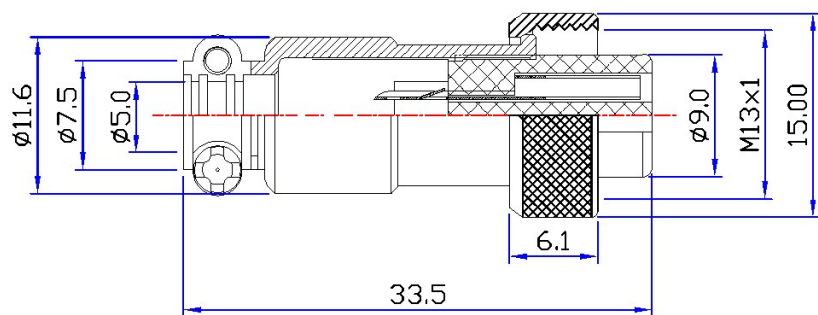

**Material and specifications**

Coupling Threaded coupling  
 Shell material Zinc alloy with Nickel Plate  
 Insert material bakelite  
 Contact material copper Silver Plate/Nickel  
 Termination Solder  
 Mating cycle 500  
 Cable diameter -20°C +85°C

Technology parameter						
NO.of contacts	2	3	4	5	6	7
Rated current(A)	5	5	5	5	5	5
Operation limit voltage(AC.V.rms)	200	125	125	125	125	125
Withstanding voltage(AC.V.rms) 1 minute	1500	1500	1500	1500	1500	1500
Insulation resistance(mΩ)	2000	2000	2000	2000	2000	2000
Contact resistance(mΩ)	5	5	5	5	5	5
Solder cup mouth aperture	∅0.8	∅0.8	∅0.8	∅0.8	∅0.8	∅0.8
Solder inter diameter	∅1.2	∅1.2	∅1.2	∅1.2	∅1.2	∅1.2

NOTE:		Tolerance	UNLESS OTHERWISE SPECIFIED TOLERANCES IN INCHES ARE 0.5-8MM±0.10MM 8-30MM±0.15MM 30-120MM±0.20MM	VOMAC	WWW.VOMAC.COM.CN	
DRAWN: XIEFENG	DATE: 22/06/15				+86 15718014206	
CHECKED:		VIEW		Name: GX12 FEMALE CONNECTOR		
APPROVALS:		UNIT	MM	Product NO. VM-GX12-F-nP		REV A
		SCALE	1 : 1	CAD FILE H/companydrawings/BD		SHEET: 1 OF 1